

EZELOAD

Automatic Wagon Loader for Bagged Commodities

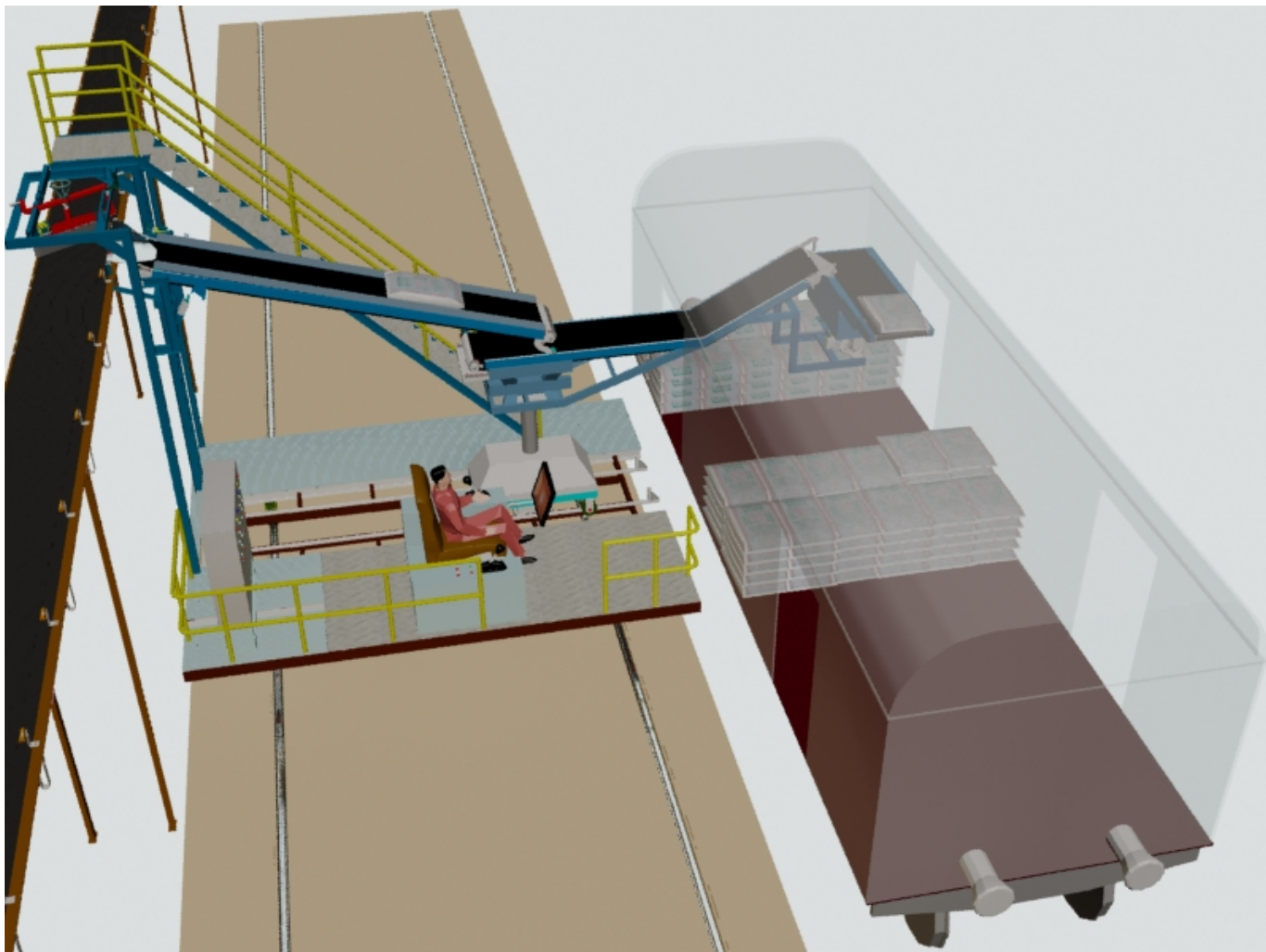

Patent pending

Whatever the load, **EZELOAD** can handle it *Efficiently & Profitably!!*

Introduction

The EZELOAD[®] wagon loader has been exclusively designed by Zebec to meet a variety of material handling requirements.

The fully automated wagon loader is customized for Indian wagons of types such as BCNHL & BCNA (Bogie covered wagon) and BOXN (Bogie open top wagon). Incorporated with a telescopic belt, it caters to complex stacking needs and results in a drastic reduction in material handling time, due to increased productivity.

Unique feature includes two designs namely:

- 1) Standard Design (As Shown),
- 2) Customized Design (tailor made according to the operational layout of the clients system)

Technical Specifications

Components

- Telescopic / articulated Conveyor
- Bag Diverter
- Belt Conveyor 1
- Belt Conveyor 2

Handling Rate

- 1,200 bags per hour.

Power Requirement

- Installed power - 20 kW
- Operating power- 14 kW

Space Requirement

- 5.8 m x 4.6 m

Movement

- Three directional movement along the X, Y, Z axis
- Telescopic conveyor luffing of (+/-) 15° with 180° slew.
- Hydraulic Lifting Arrangement (HLA)

Competitive Advantage

Fully Automated Wagon Loader

- No labour required for loading thus a drastic reduction in operational expenditure.
- Saves time and increases productivity.
- Suitable for confined space working conditions.
- Low power consumption thus benefits during long production hours.

Customized for Indian Wagons

Can be used for following wagon types:

- BCNHL,
- BCNA,
- BOXN

Additional Features

- Ergonomically designed structure
- Display System monitors the operations inside the wagon.
- Suitable for hooking upto an existing plant conveyor
- Corrosion Resistant
- Equipped with Geared Motor

Suitable For Various Bagged Cargoes



Cement



Fertilizer



MOP



Urea



DAP



Food Grains

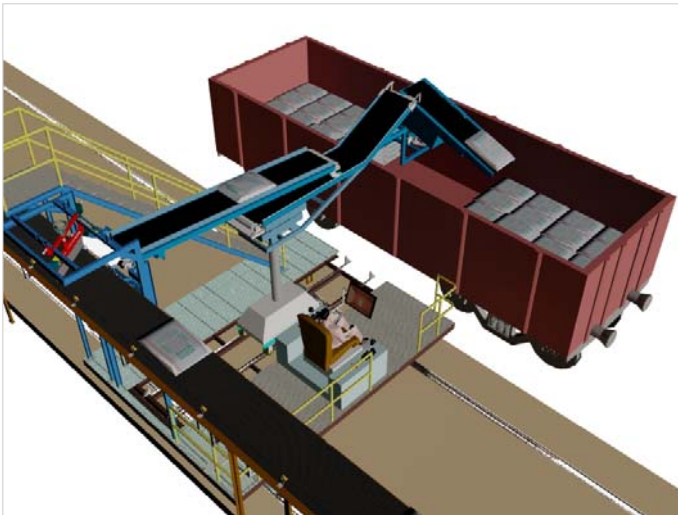

Loading process into BOXN type open wagon

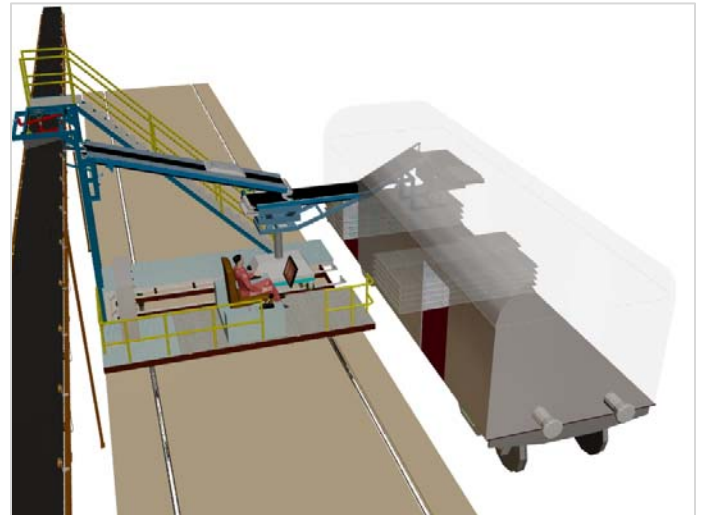

Loading process into BCNA & BCNHL type closed wagon

Loading Process

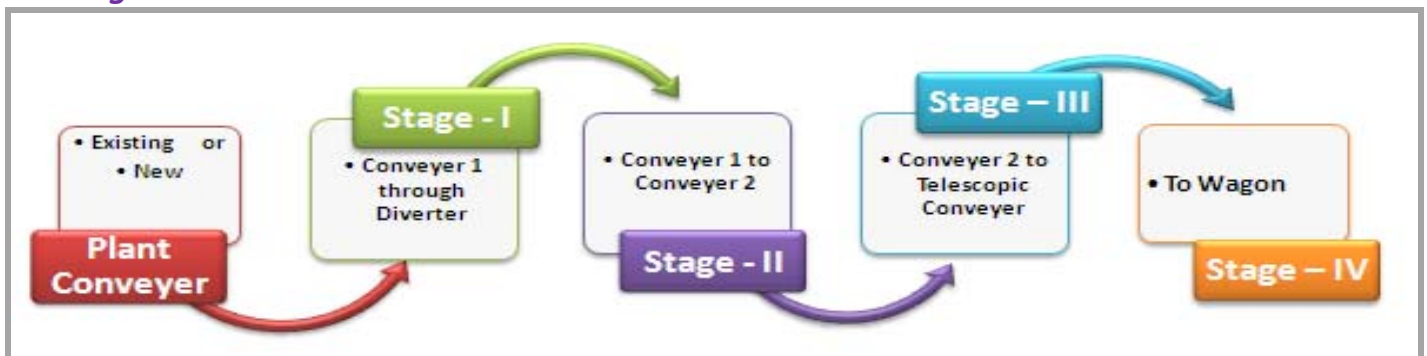

- Wagon loading process comprises of 4 dedicated stages, starting from Plant conveyor to the Wagons
- **Stage – I** : Diverter directs bags from Plant conveyor to Conveyor 1.
- **Stage – II** : Bags fall from conveyor1 to conveyor 2.
- **Stage – III** : Conveyor2 leads the bag to Telescopic/articulated conveyor.
- **Stage – IV**: Telescopic conveyor places the bag in the wagon.
- The HLA will enable that the stacking is properly done. This will ensure that even open wagons can be filled easily.

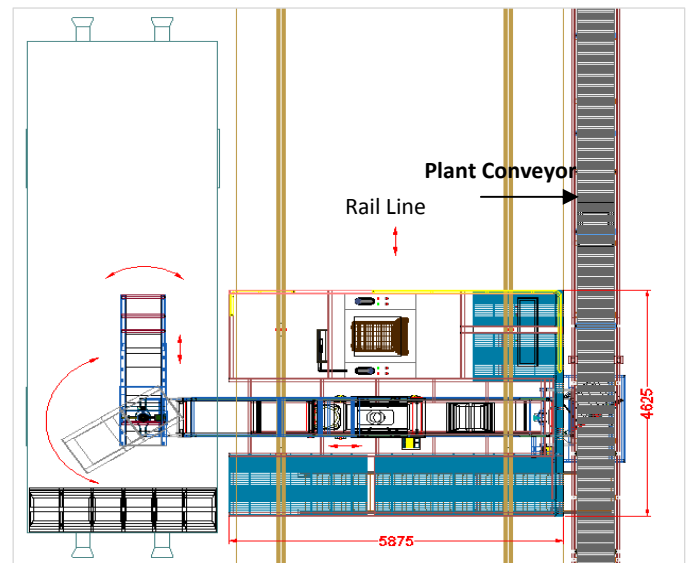

GA of Working Loader

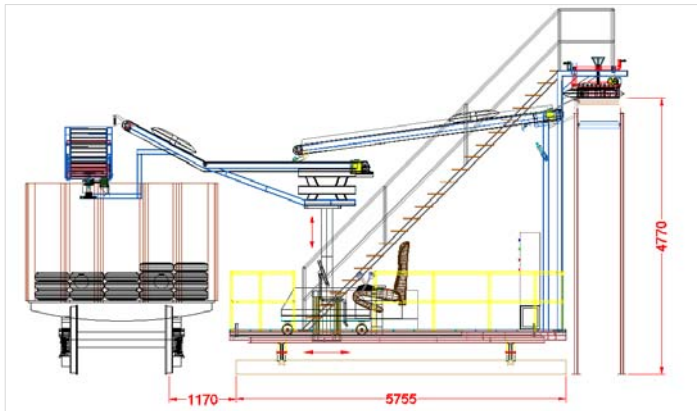

Working on BOXXN type open top wagon

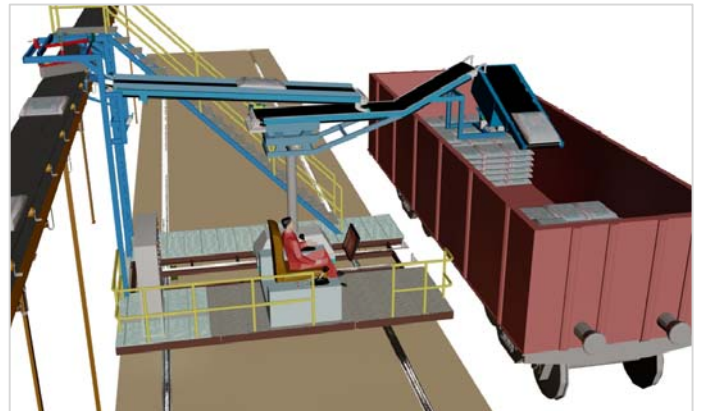

Working on BOXXN type open top wagon

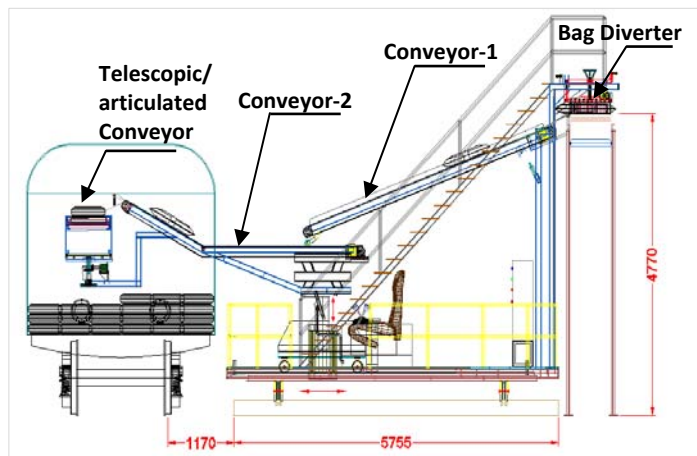

Working on BCNA & BCNHL type closed wagon

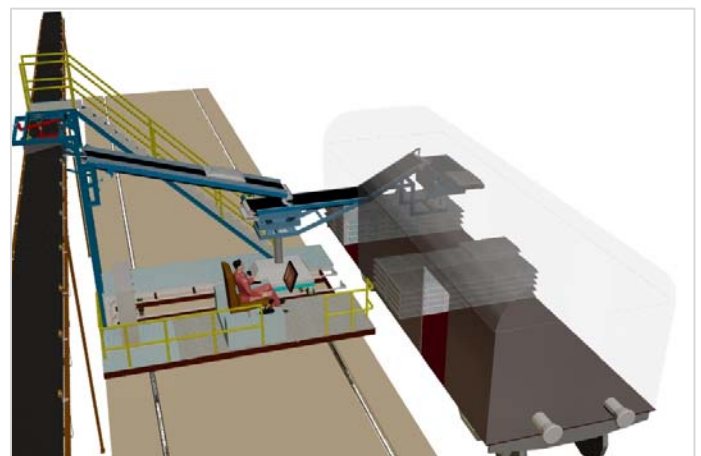

Working on BCNA & BCNHL type closed wagon

Contact Us:-

Zebec Marine Consultants & Services Pvt. Ltd.

411-414, Raikar Chambers,
Govandi (East),
Mumbai 400088, India
Phone: +91 22 42965000
E-mail: zebec@zebecmarine.com

Discretion Note - This design/specification is the property of Zebec Marine Consultants & Services, and must not be copied or replicated without the explicit permission of Zebec's Marine Consultants & Services.